

© Mountford Pigott LLP 2012
 Reproduction in whole or in part by any means is prohibited without the prior permission of Mountford Pigott LLP.
 This drawing is only to the stated scale if it is printed correctly. MPLLP cannot accept responsibility for the incorrect scaling of drawings printed by third parties.
 All dimensions are in mm unless otherwise stated.
 If this drawing forms part of an application for planning permission on behalf of the applicant named below, it shall not be used for any other purpose without the express permission of Mountford Pigott LLP.
 This drawing may incorporate information from other professionals. Mountford Pigott LLP cannot accept responsibility for the integrity and accuracy of such information. Any clarification and/or additions that are required appertaining to such information should be sought from the relevant profession or their appointment representative as listed below.

LIST OF INFORMANTS:
 CSL SURVEYS, DRG NO 16313RB 03
 INFORMANT 2
 INFORMANT 3
 INFORMANT 4
 INFORMANT 5

REVISIONS
 PLANNING APPLICATION
 DATE 01.04.14
 DRN SN
 REV -

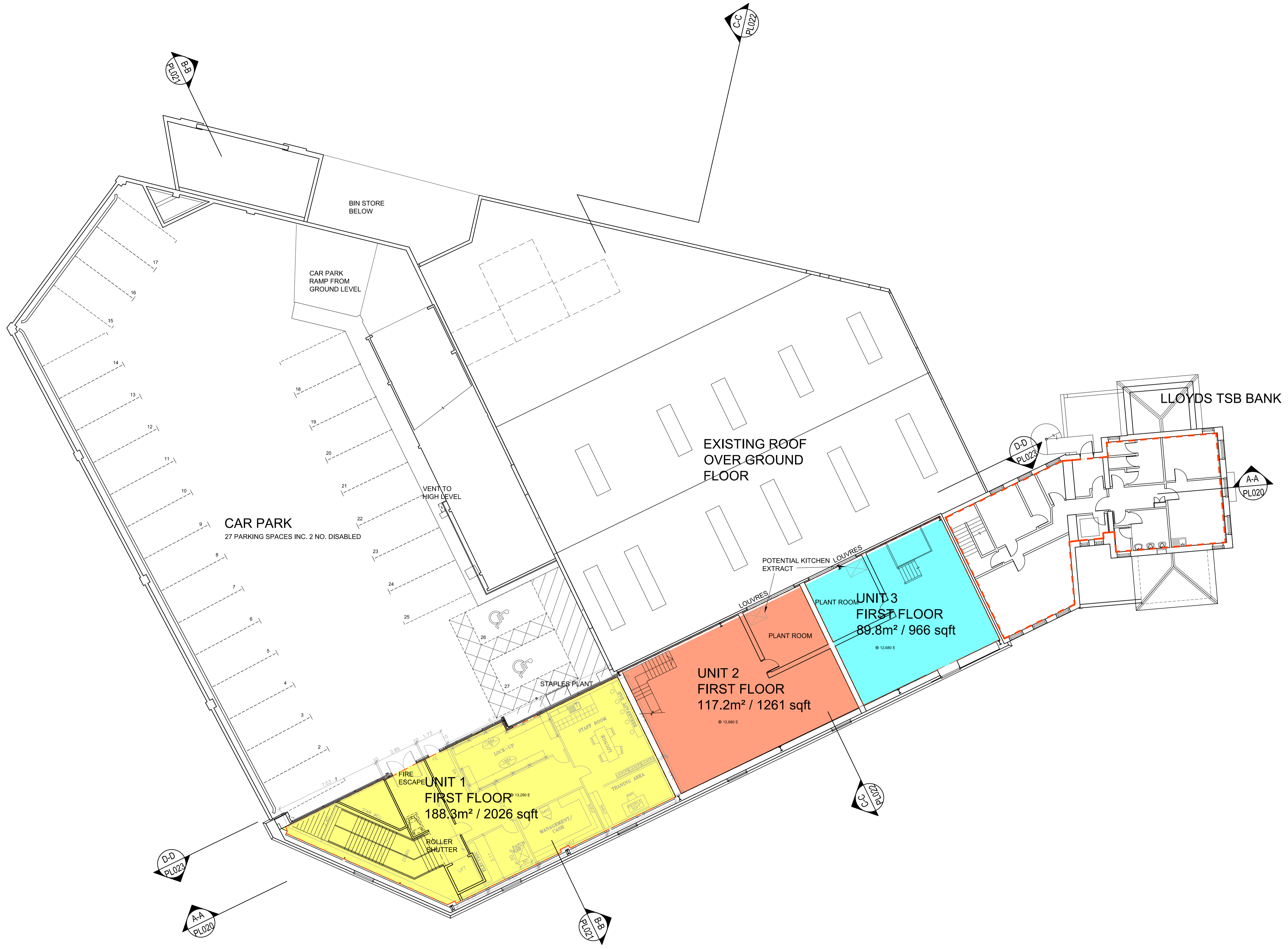

This drawing contains critical information in colour. To ensure this information is legible, only print or copy this drawing in full colour.

A Development by:
Pan Albion Group
 Property Development

CHESTERTON ROAD, CAMBRIDGE

MountfordPigott
 Architecture Masterplanning Design
PROPOSED
FIRST FLOOR PLAN
 1583-PL012-
 1:125@A1 & 1:250@A3 28.08.13
 DRAWN BY SN